

GIHR-K..DO

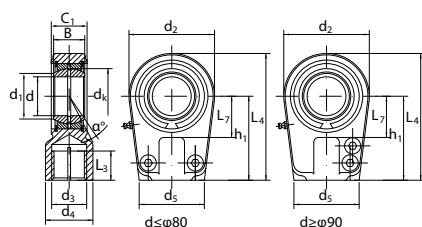

GIHR-K..DO - Rod end requiring maintenance with grease nipple, grease groove and locking nuts

Rod end with right or left-hand female thread made of a zinc plated steel housing with a GE..ES or GE..ES 2RS spherical plain bearing mounted.

For left hand thread, add L to the designation, e.g. GIHL-K 30 DO Also available with seals, e.g. GIHR/L-K 30 DO 2RS

| Designation | Dimensions mm | | | | | | | | | | | | | | Load ratings kN | |
|---------------|---------------|----------------------|----------------|-----------------------|----|----------------|----------------|-----------------------|----------------|----------------|----------------|----------------|----------------|--------|-----------------|-------------------------|
| | d | d ₃ 6H | d ₄ | L ₃ min | B | C ₁ | d ₂ | L ₇ min | h ₁ | L ₄ | d ₅ | d ₁ | d _k | a ≈ | dyn. C | stat. C ₀ |
| GIHR-K 20 DO | 20 | M16x1.5 | 25 | 17 | 16 | 19 | 56 | 25 | 50 | 80 | 46 | 24.2 | 29 | 9 | 30.0 | 72.0 |
| GIHR-K 25 DO | 25 | M16x1.5 | 25 | 17 | 20 | 23 | 56 | 28 | 50 | 80 | 46 | 29.3 | 35.5 | 7 | 48.0 | 72.0 |
| GIHR-K 30 DO | 30 | M22x1.5 | 32 | 23 | 22 | 28 | 64 | 30 | 60 | 94 | 50 | 34.2 | 40.7 | 6 | 62.0 | 106 |
| GIHR-K 35 DO | 35 | M28x1.5 | 40 | 29 | 25 | 30 | 78 | 38 | 70 | 112 | 66 | 39.8 | 47 | 6 | 80.0 | 153 |
| GIHR-K 40 DO | 40 | M35x1.5 | 49 | 36 | 28 | 35 | 94 | 45 | 85 | 135 | 76 | 45.0 | 53 | 7 | 100 | 250 |
| GIHR-K 50 DO | 50 | M45x1.5 | 61 | 46 | 35 | 40 | 116 | 55 | 105 | 168 | 90 | 55.9 | 66 | 6 | 156 | 365 |
| GIHR-K 60 DO | 60 | M58x1.5 | 75 | 59 | 44 | 50 | 130 | 65 | 130 | 200 | 120 | 66.8 | 80 | 6 | 245 | 400 |
| GIHR-K 70 DO | 70 | M65x1.5 | 86 | 66 | 49 | 55 | 154 | 75 | 150 | 237 | 130 | 77.9 | 92 | 6 | 315 | 540 |
| GIHR-K 80 DO | 80 | M80x2.0 | 105 | 81 | 55 | 60 | 176 | 80 | 170 | 265 | 160 | 89.4 | 105 | 6 | 400 | 670 |
| GIHR-K 90 DO | 90 | M100x2.0 | 124 | 101 | 60 | 65 | 206 | 90 | 210 | 323 | 180 | 98.1 | 115 | 5 | 490 | 980 |
| GIHR-K 100 DO | 100 | M110x2.0 | 138 | 111 | 70 | 70 | 230 | 105 | 235 | 360 | 200 | 109.5 | 130 | 7 | 610 | 1120 |
| GIHR-K 110 DO | 110 | M120x3.0 | 152 | 125 | 70 | 80 | 265 | 115 | 265 | 407.5 | 220 | 121.2 | 140 | 6 | 655 | 1700 |
| GIHR-K 120 DO | 120 | M130x3.0 | 172 | 135 | 85 | 90 | 340 | 140 | 310 | 490 | 257 | 135.5 | 160 | 6 | 950 | 2900 |